

CAN-EDG-5S-UP THE EDGE® LED Canopy Light – Type V Short

Rev. Date: 04/15/10

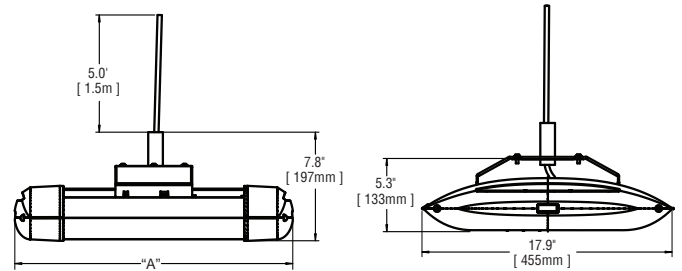

# of LEDs	40	60	80	100	120	140	160	180	200	220	240
Dim. "A"	15.75"	17.75"	15.75"	17.75"	19.75"	21.75"	23.75"	25.75"	27.75"	29.75"	31.75"

Notes:

Product	Family	Optic	Mounting	# of LEDs (x 10)	LED Series	Voltage	Color Options	Factory-Installed Options
CAN	EDG	5S ¹	UP ²	04 ³ 06 ⁴ 08 10 12 14 16 18 20 22 24	C	UL 120–277V UH Universal 347–480V 12 120V 24 240V 27 277V 34 347V	SV Silver BK Black BZ Bronze PB Platinum Bronze WH White	Please type additional options in manually on the lines provided above. 43K 4300K Color Temperature ⁵ 525 525mA Drive Current ^{6,7} DIM5 0–10V Dimming ^{8,9} F Fuse ^{10,11} HL Hi/Low (175/350/525, dual circuit input) ¹² P Photocell ^{13,14}

Footnotes

1. IESNA Type V Short distribution
2. Uplight mount
3. Uses 80 LED size with two blanks in outside positions
4. Uses 100 LED size with two blanks in outside positions
5. Color temperature per fixture; minimum 70 CRI
6. Driver operates at 525mA instead of the standard 350mA providing a higher lumen output and a shorter life
7. Available on fixtures with 40–120 LEDs
8. Control by others
9. Refer to dimming spec sheet for availability and additional information
10. When code dictates fusing use time delay fuse
11. Not available when UH voltage is selected
12. Refer to multi-level spec sheet for availability and additional information
13. Not available with multi-level options
14. Must specify voltage other than UL or UH

LED PERFORMANCE SPECS

# of LEDs	Initial Delivered Lumens – Type V Short @ 6000K	Rating***			Initial Delivered Lumens – Type V Short @ 4300K	Rating***			System Watts 120–277V	Total Current @ 120V	Total Current @ 230V	Total Current @ 277V	System Watts 347–480V	Total Current @ 347V	Total Current @ 480V	L ₇₀ Hours** @ 25° C (77° F)
		B	U	G		B	U	G								
350mA (Standard) Fixture Operating at 25° C (77° F)																
40 ³	3,833 (04)	2	0	0	3,362 (04)	2	0	0	49	0.41	0.23	0.20	51	0.15	0.12	105,000
60 ⁴	5,750 (06)	2	0	1	5,043 (06)	2	0	1	71	0.60	0.32	0.28	74	0.22	0.17	105,000
80	7,667(08)	3	0	1	6,725 (08)	2	0	1	93	0.78	0.41	0.35	96	0.28	0.21	105,000
100	9,583 (10)	3	0	1	8,406 (10)	3	0	1	116	0.98	0.52	0.43	119	0.35	0.26	105,000
120	11,500 (12)	3	0	1	10,087 (12)	3	0	1	139	1.17	0.61	0.52	141	0.41	0.30	105,000
140	13,417 (14)	3	1	2	11,768 (14)	3	0	1	164	1.39	0.74	0.63	170	0.49	0.35	105,000
160	15,333 (16)	3	1	2	13,449 (16)	3	1	2	186	1.58	0.83	0.71	192	0.55	0.40	105,000
180	17,250 (18)	4	1	2	15,130 (18)	3	1	2	211	1.77	0.93	0.79	215	0.62	0.45	105,000
200	19,167 (20)	4	1	2	16,812 (20)	4	1	2	233	1.97	1.03	0.87	237	0.68	0.49	105,000
220	21,083 (22)	4	1	2	18,493 (22)	4	1	2	256	2.16	1.13	0.95	259	0.75	0.54	105,000
240	23,000 (24)	4	1	2	20,174 (24)	4	1	2	279	2.35	1.23	1.03	282	0.81	0.59	105,000
525mA Fixture Operating at 25° C (77° F)																
40 ³	4,983 (04)	2	0	1	4,371 (04)	2	0	0	69	0.58	0.31	0.27	75	0.22	0.19	61,000
60 ⁴	7,475 (06)	3	0	1	6,556 (06)	2	0	1	110	0.92	0.49	0.41	116	0.33	0.27	61,000
80	9,967 (08)	3	0	1	8,742 (08)	3	0	1	138	1.16	0.62	0.54	145	0.42	0.32	61,000
100	12,458 (10)	3	0	2	10,927 (10)	3	0	1	177	1.49	0.79	0.68	186	0.53	0.40	61,000
120	14,950 (12)	3	1	2	13,113 (12)	3	1	2	217	1.82	0.96	0.81	226	0.65	0.48	61,000

* Utilizes magnetic step-down transformer when 525mA drive current or multi-level options are selected

** For recommended lumen depreciation data see TD-13

*** For more information on the IES BUG (Backlight-Uplight-Glare) Rating visit www.iesna.org/PDF/Erratas/TM-15-07BugRatingsAddendum.pdf



General Description

Slim, low profile, easy mounting design. Luminaire sides are rugged cast aluminum with integral, weather-tight LED driver compartments and high performance aluminum heatsinks specifically designed for LED lighting application. Uplight fixture is supplied with a heavy gauge steel mount bracket and convenient anchoring holes. Mounting bracket is provided with holes to accommodate four (4) 3/8" or four (4) 1/4" bolts (by others). The weather-tight J-Box is designed for through-wiring and wet location installations. Five year limited warranty on fixture.

Electrical

Modular design accommodates varied lighting output from high power, white, 6000K (+/- 500K per full fixture), minimum 70 CRI, long life LED sources. 120–277V 50/60 Hz, Class 1 LED drivers are standard. 347–480V 50/60 Hz driver is optional. LED drivers have power factor >90% and THD <20% of full load. Units provided with integral 9kV surge suppression protection standard. Surge protection tested in accordance with IEEE C62.41.2 and ANSI standard 62.41.2.

Testing & Compliance

UL listed in the U.S. and Canada for wet locations and enclosure classified IP66 per IEC 529. Consult factory for CE Certified products. RoHS compliant. International Dark-Sky Association approved.

Finish

Exclusive Colorfast DeltaGuard® finish features an E-Coat epoxy primer with an ultra-durable silver powder topcoat, providing excellent resistance to corrosion, ultraviolet degradation and abrasion. Bronze, black, white and platinum bronze powder topcoats are also available. The finish is covered by our 10 year limited warranty.

Fixture and finish are endurance tested to withstand 5,000 hours of elevated ambient salt fog conditions as defined in ASTM Standard B 117.

Patents

U.S. and international patents granted and pending. BetaLED is a division of Ruud Lighting, Inc. For a listing of Ruud Lighting, Inc. patents, visit www.uspto.gov.

Field-Installed Accessories

Photometrics

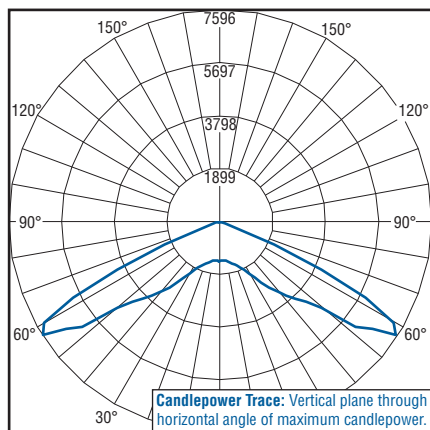

Independent Testing Laboratories certified test. Report No. ITL63747. Candlepower trace of 6000K, 120 LED Type V Short area luminaire with 11,325 initial delivered lumens operating at 350mA. All published luminaire photometric testing performed to IESNA LM-79-08 standards.

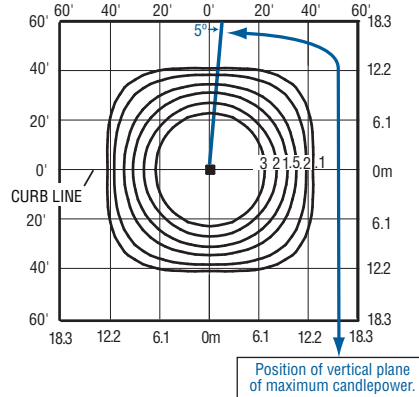

Isofootcandle plot of 6000K, 120 LED Type V Short area luminaire at 15' A.F.G. Luminaire with 11,500 initial delivered lumens operating at 350mA. Initial FC at grade.

